

Architectural and Landscape RGB LED Spot Light



LED Wave Length

R =620-630 nm
G =520-530 nm
B =460-470 nm

Optics



B49

L0120D023KP 20°
L0130D023KP 30°

B49



20°



30°

Outer Dimensions

Unit:mm

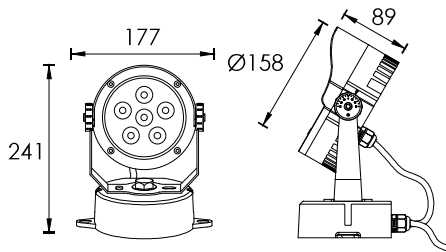

Material Specifications

Housing	12# Die-casting dark grey powder coated aluminum. T=60-80µm. Adhesion of ISO class 1/ASTM class 4B
lens	All-in-one optical lens, efficiency ≥85%
Light Window	Tempered glass, T=4mm
Cable gland	IP68 PG-9 PA66
LED	SMD5050 RGB 3 IN 1 LED
Gasket	Tooling shaped seal
Bracket	Steel aluminum
Power Cable	H05RN-F 4X0.75mm ² L=2.0m



Housing Color Option

Basic	Secondary	
Sanded Dark Grey KAP 7037	Silver Resistant Paint RAL 9006	Sanded Black RAL9005

Item	Light source	Lens	The manufacturer selected lens degree(°)θ1/2	Input voltage(V)	Typical operating current(mA)	Typical consumption(W)	Typical luminance(lm)	IK rate
FB3BDM0619	6×3W RGB 3in1 Full color	B49	30°	24V DC	R = 350 G = 350 B = 350	25.0	701	08

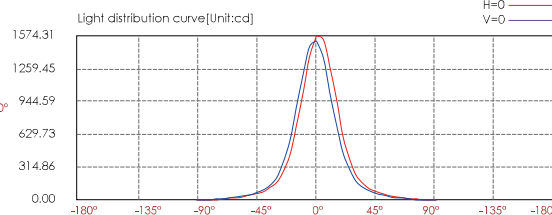
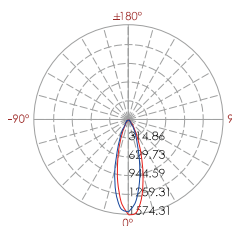
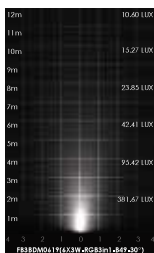

Distance	Center beam LUX	Beam width V	Beam width H
2m	381.67 LUX	1.1m	1.1m
4m	95.42 LUX	2.2m	2.2m
6m	42.41 LUX	3.3m	3.2m
8m	23.85 LUX	4.4m	4.3m
10m	15.27 LUX	5.5m	5.4m
12m	10.60 LUX	6.6m	6.5m

Ver. Spread: 30.9 Horiz. Spread: 30.2