

Linear Beam 24V DC  
IP-66 High Luminance Wall Washer

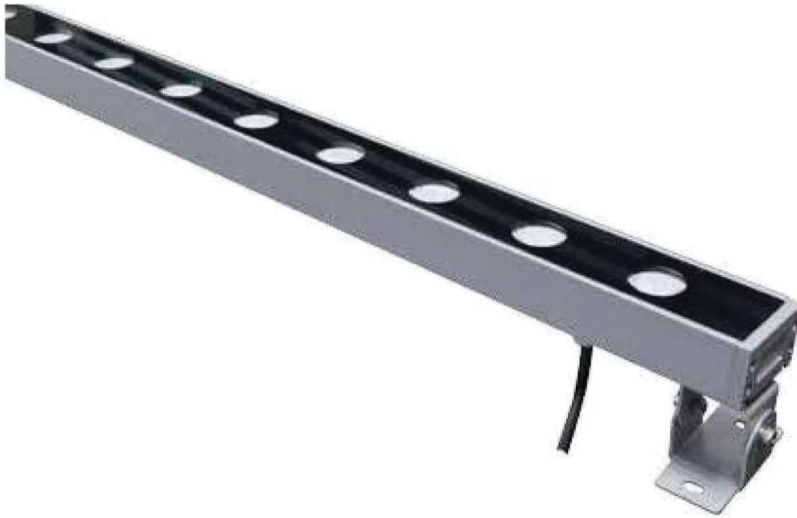

**S6LA0658**  
**S6LA1258**

**LED COLOUR TEMPERATURE**

2000K · 3000K · 6000K

**OPTICS**



A24  
L01 15° D038LK 15°X30°

**A24**

15x30°  
S6LA0658



15x30°  
S6LA1258

**OUTER DIMENSIONS**

Unit:mm

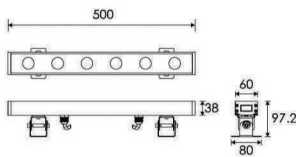

S6LA0658

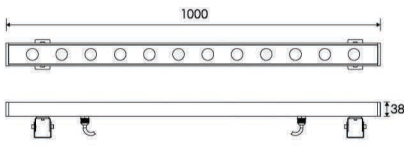

S6LA1258

**MATERIAL SPECIFICATIONS**

<b>Housing</b>	Extruded aluminum, powder coated
<b>Lens</b>	Optical lens, efficiency ≥ 85%
<b>Light Window</b>	Tempered glass, T=4mm
<b>Cable gland</b>	IP-68 PG-13.5 PA66
<b>Gasket</b>	Glass and housing are silicone sealed
<b>LED</b>	NICHIA SMD 3535
<b>Operating temperature</b>	-20°C ~ 40°C
<b>Bracket</b>	12# Die-casting powder coated aluminum
<b>Power Cable</b>	H07RN-F 2x1.5mm² L=0.25m
<b>Dimmable Support</b>	Triac PWM 1-10V Dali

**Optional Honeycomb Louver**

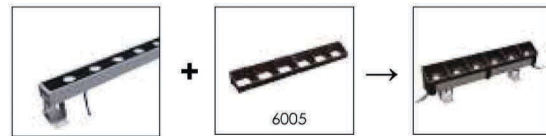

**Low voltage input (24VDC) power cord model**

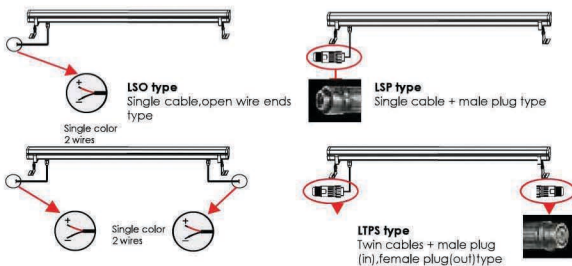

**TECHNICAL DATA**

Item	Light source	Lens	The manufacturer selected lens degree(°)θ1/2	Length L=(mm)	Input voltage(V)	Typical operating current(mA)	Typical consumption(W)	Typical luminance(lm)	IK rate
<b>S6LA0658</b>	6X4W Nichia	A24	15° 30°	525	24V DC	24V = 1200	24V = 28.8	Cool white = 1930 Warm white = 1583	05
<b>S6LA1258</b>	12X4W Nichia	A24	15° 30°	1025	24V DC	24V = 2380	24V = 57.6	Cool white = 3976 Warm white = 3261	05