

Linear Beam 24V DC  
IP-66 Slim Light Bar



**S6KA1257**  
**S6KA2457**

**LED COLOUR TEMPERATURE**

2000K · 3000K · 6000K

**OPTICS**



B27  
L01 1/2° D021YT

**B27**

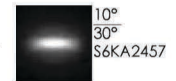
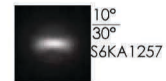

**OUTER DIMENSIONS**

Unit:mm

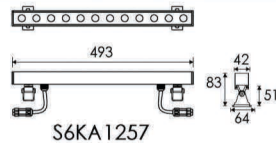

S6KA1257

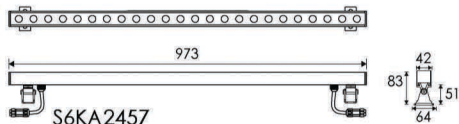

S6KA2457

**MATERIAL SPECIFICATIONS**

<b>Housing</b>	Extruded aluminum anodized finishing or powder painting
<b>Lens</b>	Optical lens efficiency≥85%
<b>Light window</b>	Tempered glass.T=4mm
<b>Cable gland</b>	IP68 PG-9 PA66
<b>Gasket</b>	Glass and housing are silicone sealed
<b>LED</b>	Single color ORSAM LED
<b>Operating temperature</b>	-20°C~40°C
<b>Bracket</b>	Hard chromeplated stainless steel SUS 304#
<b>Power Cable</b>	H05RN-F 2X1.0mm <sup>2</sup> L=0.25m (low voltage)
<b>Dimmable Support</b>	Triac PWM 1-10v Dali

**Optional Honeycomb Louver**



**Low voltage input (24VDC) power cord model**

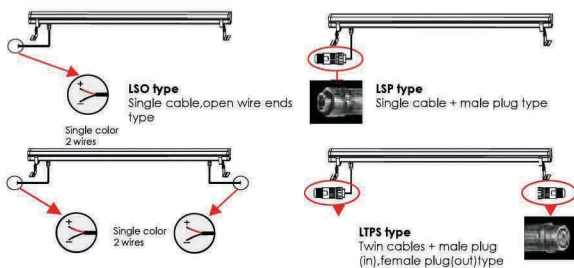

**TECHNICAL DATA**

Item	Light source	Lens	The manufacturer selected lens degree(°)θ1/2	Input voltage(V)	Typical operating current(mA)	Typical consumption(W)	Typical luminance(lm)	IK rate
<b>S6KA1257</b>	12×1.5W	B27	10° 30°	24V DC	1000	24	Cool white=1943 Warm white=1494	06
<b>S6KA2457</b>	24×1.5W	B27	10° 30°	24V DC	1985	47	Cool white=3878 Warm white=2939	06